

## SOLD Swift Conqueror 630 (2012)



### Overview

£15,995

Swift Conqueror 630 (2012)

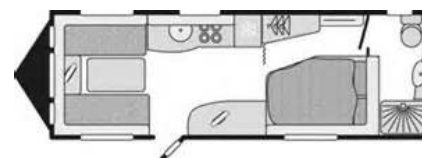

The top range Conqueror series. The 630 is a twin axle model featuring an spacious end washroom, fixed double bed, centre kitchen with a large fridge freezer and open front lounge with a sunroof and centre chest.

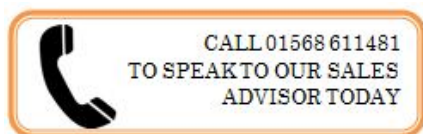

The features on the Conqueror 630 include:- twin axle with alloy wheels, large front gas locker, Al-Ko hitch stabiliser, Al-Ko ATC, Al-Ko chassis, Exteernal 240v socket and Bullfinch BBQ point, Thetford fridge/freezer, Thetford cooker with dual fuel hob, Sanyo microwave, Staus 530 directional TV aerial, loose fit carpets, Alde heating, JVC CD/radio, Thetford C-260 cassette toilet, Fire Angel smoke & CO alarms, door flyscreen, Hartal door and bin, Sargent alarm, Thermal insulation grade 3.



## Specifications

Make	Swift
Model	Conqueror 630

Internal Length	6.27m / 20'7"
External Length	7.99m / 26'3"
Width	2.31m / 7'7"
Unladen Weight	1654kg
MTPLM	1814kg
Awning Size	1065cm
Warranty	6 months