

## SOLD Pilote Mooveo C647 (08 plate)

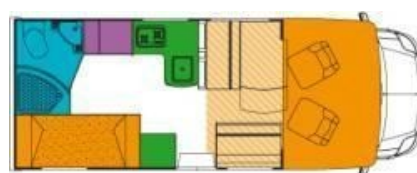

## Overview

be ideal for a small, medium or large family group or up to six friends sharing. There is plenty of living and sleeping space in the Mooveo C647. The efficient Renault 2.5 litre turbo diesel engine and power assisted steering make the C647 easy to drive and park. For your comfort while



travelling there is cab air conditioning available.

The Mooveo C647 has a good size overcab double bed and adult-size bunk beds on the side wall to the rear of the habitation area. The lounge/dining area just behind the passenger cab can also be converted into a further double bed.

The L-shaped integrated kitchen contains an oven, grill and hob, 3-way fridge freezer, sink unit, food storage cupboards, cooking utensils, cutlery and crockery. The generous size washroom, tucked away at the rear of the habitation area, allows better privacy than in some motorhomes. You will find a shower, cassette toilet and washbasin within.

The Mooveo C647 is fully winter-proofed, with effective insulation and double glazing. The power management system can be used to supply hot water and heating as required. There is plenty of storage space in the C647 for bulky items and sports equipment. The lower rear bunk can be lifted to provide a storage area. There is also a bicycle rack fitted on the exterior of the vehicle at the rear.

- Passengers 4
- 4 x 3pt seat belts
- Berths 6
- Overcab double bed
- Middle dinette bed (approx 185 x 124 cm)
- Bunk beds (2)
- Kitchen
- Washroom
- Blown air heating
- Category 2-1 Thatcham alarm (3868 LCV)
- Cab air conditioning
- Fiamma Bicycle rack (4)

## Specifications

---

Chassis	Renault Traffic
Miles	19500
Engine	6 speed manual 2500cc TD
1st registered	01-08-2008
Previous Owners	4
Gross Weight	3500kg
MIRO	3025kg
External Length	6.39m / 20'10"
Height	3.05m / 10'0"
Width	2.35m / 7'7"
Fuel	Diesel

## Warranty

---

This motorhome will have a full engine & habitation service prior to collection. It will also have 12 months MOT and 6 months full warranty,