

SOLD Autocruise Wentworth (52 reg)



Overview

£19,995

An exquisite 2 berth motorhome finished in a style and standard without compromise. It has a rear corner wet room, centre kitchen with plenty of storage and workspace and a lounge area complimented by the swivel seats.

The features include:-reversing camera, 2 x external lockers, gas locker for up 2x7kg gas bottles (not included), Fiamma F45 + awning, Omnistep, parking distance sensor, Electrolux fridge, cooker with grill and oven, Status 315 aerial, Truma Combi boiler, Thetford C-200 cassette toilet, Thermal insulation grade 2, electric windows & mirrors, fresh water tank 80 litres, waste 48 litres,

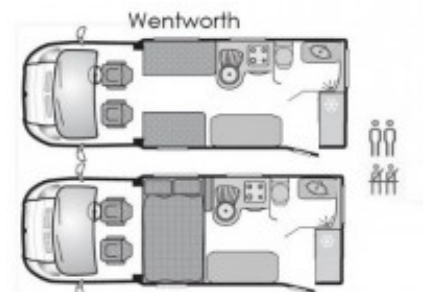

Specifications

Engine	Peugeot 2500cc
MIRO	3945kg
MTPLM	3400kg
Total Height	2.93m / 19'7"
Total Length	6.76m / 22'2"
Total Width	2.50m / 8'2"
Chassis	Peugeot Boxer 330 LXLWB HDI
Millage	25550
Fuel	Diesel
Gears	Manual 5 speed
1st Register	13/09/02
Previous Owners	1
Warranty & MOT	12 months
Max Train Weight	4700kg

Warranty

This motorhome will have a full service before collection, and 12 months full warranty.

Please enquire for further details.