

SOLD Bailey Unicorn 3 Madrid (2017)



Overview

SAVE £3200 NO DELIVERY CHARGE

RECOMMENDED PRICE £22964

The NEW Unicorn 3 range is out. The All New and improved Madrid layout is here.

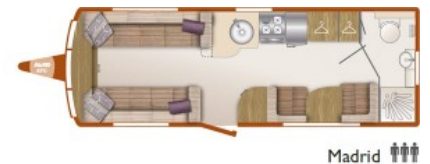

Specifications

Make	Bailey
Model	Unicorn Madrid
Internal Length	5.83m / 19'2"
External Length	7.37m / 24'2"
Width	2.28m / 7'6"
Unladen Weight	1350kg
MTPLM	1496kg
Awning Size	1045cm
Warranty Internal/External	3 yrs / 10 yrs

Exterior Features

ALU-TECH BODY SHELL

- Structural interlocking aluminium extrusion framework with no external fixing points and concealed awning channels on both sides
- Five part fully bonded exterior panel assembly system
 - Upper body panels manufactured using superior bead application laminating technology for a stronger more consistent bond
 - Upper body panels built using a timber free construction, incorporating a composite plastic internal skeleton, a high density polystyrene insulation and a GRP inner wall lining
 - Upper body panels cloaked in a single sheet impact resistant GRP outer skin for extra durability
- Supplied with a 6-year transferable bodyshell integrity guarantee and a 3-year transferable manufacturers components warranty*
- 4-year transferable extension to bodyshell integrity guarantee available as a cost option (making 10 years in total)*
- EN-1645 Grade III classification for heating and thermal insulation (cold chamber tested)
- European Whole Vehicle Type Approved & certified by the National Caravan Council to be European Standard compliant

EXTERIOR FEATURES

- **NEW** 'Polar white' bodyshell
- 13 pin DIN standard caravan connecting cable
- **NEW** aero-dynamic & aesthetically enhanced rear bodyshell profile
- **NEW** AL-KO one-piece galvanised steel chassis, braking system and running gear

- **NEW** flush-fit front impact resistant bumper with integral chrome grab handles
- **NEW** flush-fit rear impact resistant bumper with integral chrome grab handles & LED light clusters
- **NEW** design step up a-frame fairing
- 14" TUV tested alloy wheels
- Heavy duty rear corner steadies
- **NEW** Hartal GRP skin two part large aperture exterior door with window, blind and waste bin
- LED awning light with integral water management system
- Double glazed Polyplastic opening vertical skylight in front dome
- Double glazed Polyplastic opening windows throughout
- Midi and mini Heki roof lights located throughout the main habitation area
- Centrally mounted easy-access gas locker for enhanced stability and reduced nose weight
- Exterior 230v socket and gas BBQ point
- **NEW** 230v power inlet for mains hook-up
- Status 550 telescopic directional digital television aerial
- **NEW** external satellite connection point
- **NEW** centrally located easy access large exterior storage locker with moulded liner
- **NEW** co-ordinating graphics scheme

Interior Features

SPACE

- Internal headroom of 1.96m (6'5") throughout the length of the caravan
- Body width of 2.28m (7'6")
- Internal floor space up to 15% larger**
- Front seats up to 10% longer**
- Kitchen worktop space up to 10% larger**

Furniture

FURNITURE & SOFT FURNISHINGS

- **NEW** Bailey "Mendip Ash" furniture finish
- Large front window shelf with heating vents
- **NEW** recessed 2-drawer front chest with slide out occasional table and soft close drawers
- **NEW** twin concealed storage pockets
- **NEW** double skin bed box frames with beech sprung tops and drop down flaps
- **NEW** slatted front bed make-up system on easy-glide track

- **NEW** leatherette skylight surround with integral ambient and task lighting
- **NEW** angled backrest and seat ventilation boards for enhanced heating efficiency
- **NEW** lightweight freestanding table with dedicated storage
- **NEW** vented aircraft style overhead locker system with split level storage and domestic soft close metal hinges
- Structural locker dividers with greater load bearing capacity
- **NEW** dual finish Italian design overhead locker doors
- **NEW** dual-position slide-out TV bracket (model specific - accommodates a TV up to 18.5" in size)
- **NEW** premium quality chrome finish fixtures and fittings
- **NEW** internal grab handle for ease of access in and out of the caravan (model specific)
- **NEW** leatherette multi-functional storage pouch
- **NEW** "Italian stone" finish kitchen and washroom worktop laminate
- **NEW** drop-down kitchen worktop extension
- **NEW** co-ordinating Perspex splash-back
- **NEW** design fixed double beds with aluminium frames and gas strut assisted opening mechanism
- Solid domestic style washroom door with domestic metal handle
- Fitted linen basket in washroom
- Fully sprung upholstery (except split cushions used in bunk make-up) featuring premium quality fabrics, high density filling and superior cushion construction and a De-Luxe sprung mattress (model specific)
- **NEW** Standard Kensington soft furnishings with co-ordinating curtains, four shaped arm rests, two large square and two small rectangular scatter cushions
- **NEW** Optional Trafalgar soft furnishings co-ordinating curtains, four shaped arm rests, two large square and two small rectangular scatter cushions
- **NEW** textured finish durable floor vinyl
- **NEW** deep pile loose fit drop in carpets (55 oz pile weight)

Services

ELECTRICAL SYSTEM

- **NEW** Truma 100 watt solar panel
 - **NEW** 230v power supply with up to seven new design interior sockets
 - TV station with 230v, 12v and two aerial sockets
 - **NEW** 12v internal lighting system including LED down-lighters and directional spotlights
 - **NEW** 12v shower cubicle lighting
 - **NEW** centrally located under floor leisure battery storage locker
 - **NEW** centrally located electrical control panel
 - Domestic style consumer unit with dedicated access door
 - Switch mode battery charger with 20 amps output
-

- RCD/MCB protection for mains electric system
- 25 metre mains connecting lead

WATER & GAS SYSTEM

- **NEW** Alde Hydronic Compact 3020 programmable radiator heating system with combined water heating
 - **NEW** ALDE 3020 boiler for improved fuel economy
 - **NEW** Alde touch screen user-friendly control panel
 - **NEW** washroom panel radiator
 - Dual fuel 6.4 Kw gas and up to 3.15 Kw electric power sources
- Propane/Butane 30mb gas regulator mounted in gas locker compartment
- **NEW** On-board 40L water tank (twin axles only)
- **NEW** Whale high flow submersible pump
- Inboard rigid pipe waste plumbing system
- Stainless steel circular kitchen sink with swan-neck mixer tap, washing up bowl, drainer and chopping board
- Thetford C-260 cassette toilet with integrated header tank
- Inboard shower unit with ceramic ball mixer tap and Ecocamel shower head
- **NEW** large fully lined square shower cubicle with domestic style door and storage shelf
- Extendable shaving mirror in washroom

Equipment

KITCHEN EQUIPMENT

- **NEW** exclusive Dometic 133 litre tower refrigerator with electronic ignition (single axles only)
- Dometic 190 litre fridge and freezer with electronic ignition (twin axles only)
- Thetford Caprice combined oven, grill and hob with electronic ignition and flame failure device
- Thetford dual-fuel hob with electric hotplate and 3 gas burners
- Stainless steel 800 watt microwave oven

GENERAL EQUIPMENT

- Remis pleated flyscreen and blinds to principal windows
- Remis 2-part pleated flyscreen and blind to vertical skylight
- Hartal pleated full length flyscreen to exterior door
- **NEW** branded DAB Radio/CD/MP3 player with iPod / MP3 player USB connection point
- Branded dual cone stereo speakers for superior sound quality
- Caravan clock

Safety & Security

SAFETY & SECURITY

- AL-KO ATC Trailer Control System
- AL-KO AKS 3004 Stabiliser
- AL-KO shock absorbers
- WSL Individually Laser Balanced wheels fitted with 'Michelin' tyres and anti-tamper WSL Safety Bolts
- Wind down floor mounted spare wheel carrier and spare wheel (steel spare wheel)
- AL-KO caravan jack
- AL-KO Secure portable wheel lock (two for twin axle models)
- **NEW** TRACKER Retrieve with 5 year standby battery life (including first 3 months subscription fee)
- **NEW** High security one key operation throughout
- CRiS identity number etched to windows and caravan chassis
- Concealed security data chip within caravan construction
- Smoke alarm
- Carbon monoxide alarm

Optional Extras

*Terms and conditions apply. Please visit the [Vehicle Warranty Section](#) for more information.

** Size comparison with equivalent models in the previous Unicorn range

Price excludes retailer delivery charge of £565 (including VAT)